

# MAXHUB

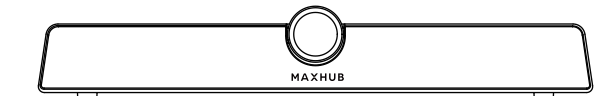

## Integrated video conference terminal User Manual

Note: The product images are for illustrative purposes only and may slightly differ in appearance, colour, size, etc. from the actual product.

### ● Safety Warning and Precautions

Before using and operating this device, please read thoroughly and comply with the following precautions in order to prevent accidents or abnormal operation.

#### 1) Operating Environment

- Do not place the product in dusty and humid environments in case of internal short circuit.

- Do not place the product near heating devices(such as electrical heater).

- Operating temperature is 0–40℃, operating humidity is 10%–90%RH. Please use the product accordingly.

#### 2) Children Safety

The product and accessories may contain some small parts. Please keep them from children to avoid accidental swallowing or danger.

#### 3) Power supply

Please use the standard power adapter.

#### 4) Keep Dry

The product is NOT waterproof.Please keep it dry.

#### 5) Maintenance

- Please contact technical support for maintenance services.
- Do NOT insert any sharp or pointed object into the device.
- Prevent the device from falls and collisions with other objects,which may cause damages.

### ● Statement

1) Intellectual property right statement: The patents cover the hardware design and software of this product. Anyone reproduces the product or the contents of this instruction without prior written permission from the Company shall be liable to legal prosecutions.

2) The description, illustrations, etc. in this document may subject to change per the latest product specification and performance.

3) The product images are for illustrative purposes only and may slightly differ in appearance, colour, size, etc. from the actual product.

4) The Company reserves the rights to improve and change the appearance and design of the product without notice.

**Note:** Users may find the type approval code of this product on the product’ s nameplate.

### ● Accessories introduction

Please check the following items in the product box.

HDMI cable x1	Wall-mounted x1
Peeping cover x1	Power adapter × 1
Battery × 2	Remote control x1
USB cable × 1	Use manual x1

### 1. Product Function

Please familiarize yourself with the interface and buttons of the device before using this device.

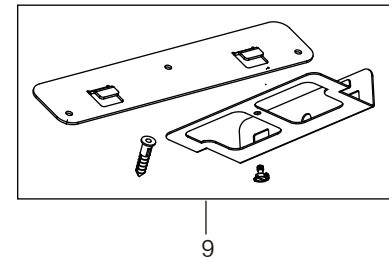
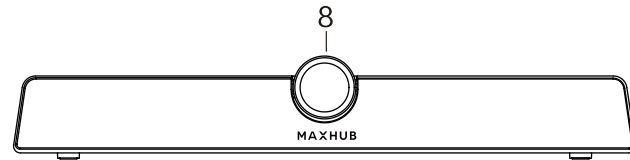
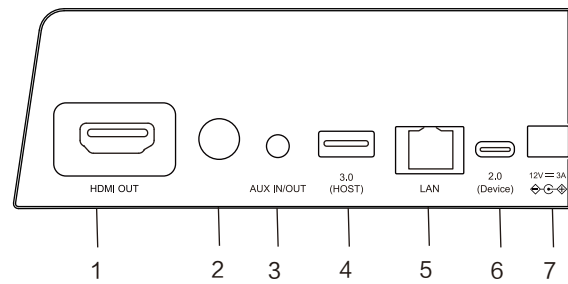

- 1) HDMI OUT: Connect to the devices with HDMI input function
- 2) POWER : Tap to enter energy-saving,press and hold for at least 2 seconds to enter standby mode
- 3) AUX IN/OUT: Used for external audio equipment

- 4) 3.0: USB 3.0,used for upgrading and connecting with external mouse/keyboard
- 5) LAN: Connect RJ45 terminals
- 6) 2.0: Device,can be connected to a computer through a USB Type–A to Type–C data cable, providing the computer with camera, microphone and speaker
- 7) DC: Used for 12V power input power supply
- 8) Camera: Shooting performance
- 9) Hanging components

### 2. Mounting

- 1) Placed directly on the desktop.
- 2) Wall-mounted: Fix the bracket onto the Wall with screws, then place the integratedvideo conference terminal onto the bracket.

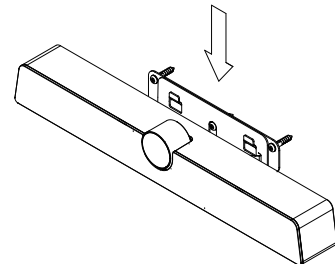

- 3) Use with panel: Fix the bracket onto the supporting bracket with screws, then place the integrated video conference terminal onto the bracket.(The bracket needs to be purchased separately.)

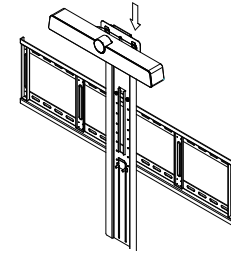

**Note:** The connection of different samples may slightly differ. Please refer to the actual product.

### 3. Quick Start

- 1) Please use HDMI cable to connect this product to the monitor.
- 2) To turn on the device, press the power button on the back of the product or use remote control.
- 3) For the first use, please complete the network connection and device activation during device boot.
- 4) After successful activation, this product function would be fully functional.

### ⚡ Federal Communication Commission Interference Statement

This equipment has been tested and found to comply with the limits for a Class B digital device, pursuant to Part 15 of the FCC Rules. These limits are designed to provide reasonable protection against harmful interference in a residential installation. This equipment generates, uses, and can radiate radio frequency energy and, if not installed and

used in accordance with the instructions, may cause harmful interference to radio communications. However, there is no guarantee that interference will not occur in a particular installation. If this equipment does cause harmful interference to radio or television reception, which can be determined by turning the equipment off and on, the user is encouraged to try to correct the interference by one or more of the following measures:

- Reorient or relocate the receiving antenna.
- Increase the separation between the equipment and receiver.
- Connect the equipment into an outlet on a circuit different from that to which the receiver is connected.
- Consult the dealer or an experienced radio/TV technician for help.

**FCC Caution:**

This device complies with Part 15 of the FCC Rules. Operation is subject to the following two conditions:

- 1) This device may not cause harmful interference, and
- 2) this device must accept any interference received, including interference that may cause undesired operation.

Caution: The user is cautioned that changes or modifications not expressly approved by the party responsible for compliance could void the user's authority to operate the equipment.

This equipment complies with FCC radiation exposure limits set forth for an uncontrolled environment. This equipment should be installed and operated with a minimum distance of

20cm between the radiator and any part of your body.

**Non-modification Statement:**

Changes or modifications not expressly approved by the party responsible for compliance could void the user's authority to operate the equipment.

**IC Radiation Exposure Statement for Canada**

This device contains licence-exempt transmitter(s)/ receiver(s) that comply with Innovation, Science and Economic Development Canada's licence-exempt RSS(s). Operation is subject to the following two conditions:

- 1) This device may not cause interference.
- 2) This device must accept any interference, including interference that may cause undesired operation of the device.

L'émetteur/récepteur exempt de licence contenu dans le présent appareil est conforme aux CNR d'Innovation, Sciences et Développement économique Canada applicables aux appareils radio exempts de licence. L'exploitation est autorisée aux deux conditions suivantes :

- 1) L'appareil ne doit pas produire de brouillage;
- 2) L'appareil doit accepter tout brouillage radioélectrique subi, même si le brouillage est susceptible d'en compromettre le fonctionnement.

This equipment complies with ISED RSS-102 radiation exposure limits set forth for an uncontrolled environment. This equipment should be installed and operated with a minimum distance of 20cm between the radiator and any part of your body.

Pour se conformer aux exigences de conformité CNR 102 RF

exposition, une distance de séparation d'au moins 20 cm doit être maintenue entre l'antenne de cet appareil et toutes les personnes. The device for operation in the band 5150 – 5250 MHz is only for indoor use to reduce the potential for harmful interference to co-channel mobile satellite systems Les dispositifs fonctionnant dans la bande de 5 150 à 5 250 MHz sont réservés uniquement pour une utilisation à l'intérieur afin de réduire les risques de brouillage préjudiciable aux systèmes de satellites mobiles utilisant les mêmes canaux.

**7668 RF & Power**

Frequency Range	Output Power (Max.)
2412 to 2472 MHz	19.17 dBm
5150 to 5250 MHz	19.23 dBm
5725 to 5825 MHz	13.02 dBm

Antenna Type:PCB

Antenna Gain: 2.4G Wifi 2.44dBi;5G wifi(5150 to 5250 MHz)2.02dBi;

5G wifi (5150 to 5250 MHz ) 2.85dBi

Antenna Impedance:50Ω

**8821 RF & Power**

Frequency Range	Output Power (Max.)
2412 to 2472 MHz	18.67 dBm
5150 to 5250 MHz	12.54 dBm
5725 to 5825 MHz	12.44 dBm

Antenna Type:FPC

Antenna Gain: 2.4G Wifi 5.95dBi;5G wifi(5150 to 5250 MHz)3.48dBi;

5G wifi (5150 to 5250 MHz )2.32dBi

Antenna Impedance:50Ω

Hereby, Guangzhou Shrui Electronics Co., Ltd. declares that the radio equipment type UC S10 is in compliance with Directive 2014/53/EU.

The full text of the EU declaration of conformity is available at the following internet address: [www.maxhub.com](http://www.maxhub.com).

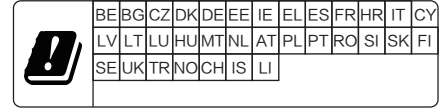

This symbol, affixed to the product or its packaging, indicates that the product must not be processed with household waste. It must be brought to an electric and electronic waste collection point for recycling and disposal. By the appropriate disposal of this product you also help in preventing potentially negative consequences for the environment and human health. The recycling of materials helps preserve our natural resources. For further information regarding the recycling of this product, please contact your municipality, local waste disposal centre or the store where the product was purchased.



**Remote Control**

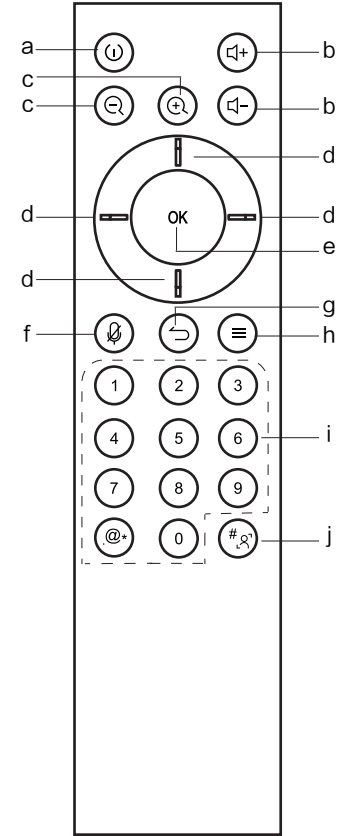

- a. : Power Button,press to start the power off countdown. Press and hold for 3 seconds to power off.
- b. : Volume Button, press to adjust the system volume.
- c. : Digital Zooming,press to digitally zoom the camera. (Available only when auto framing is disabled). After zooming in, the direction button may move the picture.

- d. Direction Button: Press the direction buttons to move the camera or selection.
- e. OK Button: Confirm the selection. During digital zooming, press this button would restore the default view.
- f. : Mute Button,press the turn on or off the microphone.
- g. : Return Button: Press to return to previous menu or quit an app.
- h. : Menu Button,press to invoke the menu in different interfaces.
- i. Number keys and : Number Buttons,press to input the numerals.
- j. : # & Auto Framing Button: Press to type in “#” . Press and hold to enable/disable the auto framing feature. ("" means open, "" Means off.)

**Presets:**

- 1) Set and switch the presets in settings.
- 2) Press and hold the number button "1/2/3" for 2 seconds to save the current view as a preset.
- 3) Each preset may including zooming level, viewing angle information. Up to three presets are supported.
- 4) Press 1/2/3 to switch amongst the presets.

**HDMI**  
HIGH-DEFINITION MULTIMEDIA INTERFACE  
NOTICE: The terms HDMI and HDMI High-Definition Multimedia Interface, and the HDMI Logo are trademarks or registered trademarks of HDMI Licensing LLC in the United States and other countries.